

Explanation / notes

IMPORTANT SAFETY INSTRUCTIONSGeneral safety instructions (please read carefully):**DANGER**

To reduce the risk of an electric shock:

1. Disconnect the power supply and disable the battery before cleaning.

WARNING

To reduce the risk of burns, fire, electric shock or personal injuries:

1. Disconnect the power supply to the charging station or disable the battery as soon as they are not in use.
2. Do not use outdoors
3. The batteries may only be used with the original himolla charger that is supplied.
4. Keep the cable away from hot surfaces.
5. Check the charger, cable and plug before each use. If you should notice any damage to the charger, external cable or battery, please refrain from using the device .
6. Do not open the charger or the battery itself. Only arrange for them to be repaired or replaced by qualified personnel using original spare parts.

7. Please ensure that no children play with the charger or battery. Supervise children or people with a lack of physical, sensory and mental capabilities who are not able to handle the battery unit properly and understand its dangers.
8. Risk of electric shock – connect your charger only to a properly earthed power socket.
9. Keep the charger and, if applicable, the batteries away from rain and moisture. The ingress of water into a charger increases the risk of an electric shock.
10. Do not use the charger on a highly flammable surface (such as paper, fabrics etc.) or in a flammable environment. There is a risk of fire due to the heating of the charger that occurs when charging the battery.
11. **People with pacemakers or other implants:**
Low-voltage electric motors are used in your himolla product. This also applies to the electronic drive and its signalling. Nevertheless, people with pacemakers should ask their doctor or the supplier of the pacemaker or implant whether it is failure-prone and what precautions should be taken to prevent any interference!

Explanation / notes

Instructions for using a himolla product with battery

General information:

It is crucial that you read and observe the enclosed instructions carefully to avoid problems when using your himolla product that is equipped with a battery!

Check the goods supplied (packaging and content) for damage before use.

Make sure that you handle the parts carefully and avoid any kind of impact. In addition, avoid exposure to extreme heat or cold when storing, assembling and using the upholstered furniture and therefore the battery.

Use only the manufacturer's original spare parts when charging your battery and when using your himolla product.

Technical data:

Charger

Supply voltage (in volts)	90-240 V AC
Power frequency (in hertz)	50-60 Hz
Operating voltage (in volts)	max. 36 V DC
Power consumption in idle state (in milliwatts)	< 500 mW

External lithium-ion rechargeable battery

Battery type	Lithium-ion battery (Li-ion)
Capacity	2000 mAh
Output voltage	33.6 VDC
Temperature range	0°C - + 60°C
Charging time	~ 7 h

Explanation / notes

Package contents:

- 1 Battery, 2000 mAh
- 2 Charger unit
- 3 Power cable
- 4 Switching power supply
- 5 Adapter cable
- 6 Lead for power supply

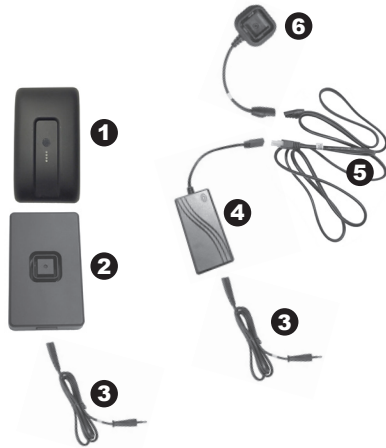
**Using the battery:**

The battery has a sleep or idle mode to protect it from discharging during transport and storage.

If only one light-emitting diode (hereinafter referred to as LED) lights up green after activating the battery, it needs to be charged with the charging station included with the delivery before installing it in and using the himolla product.

The following steps must be performed to activate the battery:

- Press the black button on the battery briefly – the battery is activated.
- The green LEDs show you the charging status of the battery once it has been activated. The more LEDs that light up, the higher the current battery charge.

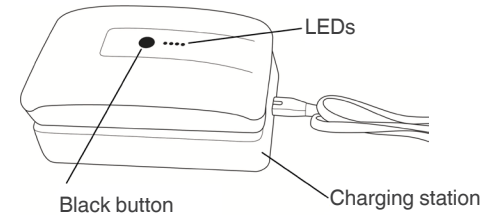

The battery can now be plugged into the available connector (also for the switching power supply) on your himolla product (see illustration).

Press the black button for at least three seconds to deactivate the battery (if it is not to be used for a long period of time while you are away etc.); you will then hear a triple beep and the battery enters its idle or sleep mode.

Explanation / notes

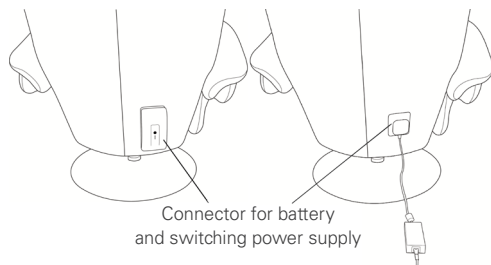
The himolla product is now ready to use:**Charging the battery:**

The battery is equipped with visual LEDs (green or red) and an acoustic (beep) battery status indicator.

- Green LED light = Charging status for trouble-free use; the LEDs light up green during the adjustment process and go out after approx. two minutes. They light up only when another adjustment is made.
- Red LED light and beep during the adjustment process = charging prompt (which we urgently advise you to follow) due to the low residual charge. In this case, stop using it immediately and plug the battery into the charger.

The battery must be plugged into the charging station in order to charge it. The charging process starts automatically.

The flashing LEDs indicate that the battery is charging (the LEDs - up to four - light up continuously depending on the charging status). The four illuminated LEDs go out after 90 seconds when the battery is fully charged.

The charging status of the battery can be indicated through the LEDs integrated in the battery by pressing the black button; the battery is fully charged if four green LEDs come on .

Maintenance and care:

- The battery, charger and switching power supply are maintenance-free.
- Clean the casing now and again with a dry cloth.
- Do not use any cleaning agents as these may attack the casing.

Disposal:

Please dispose of the battery, charger and switching power supply according to the respective statutory regulations in your country.

